

**VIBRATING SCREEN FOR POWDER**

**SET 700-900-1200**

**TECHNICAL FEATURES**

DATA	U.M.	1200	900	700
Number screening nets	No.	1		
Screening surface	m <sup>2</sup>	1,35	0,92	0,64
Power	kW	1,15	0,65	0,62
Centrifugal force	N	16922	10928	7004
Motorised vibrator	Type	MVE 1700/15	MVE 1100/15	MVE 700/15
Weight	kg	400	340	280

**STRUCTURAL FEATURES**

- Stainless steel frame
- Elastic system with rubber vibration dampers
- Unidirectional motorised vibrator
- Mesh with hooks and automatic spring-operated pre-tensioning system

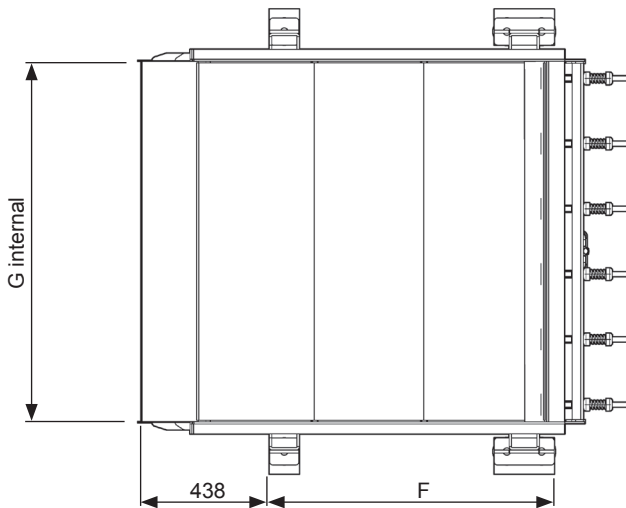
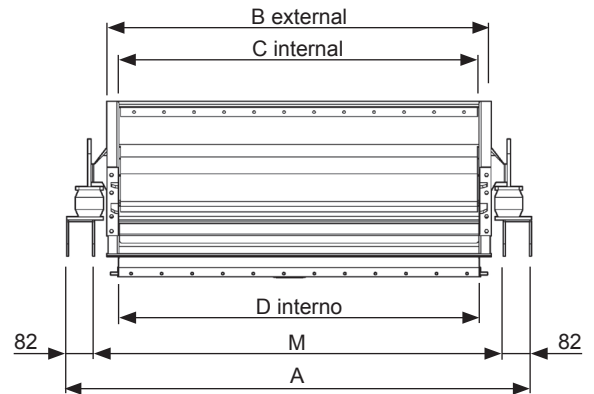
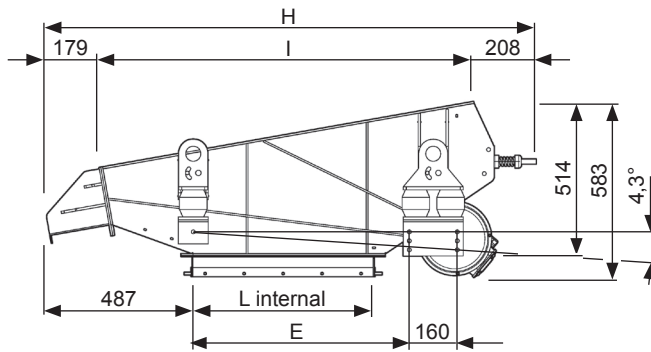

**NOTE!**  
The support trolley is optional

Mod./Size	A	B	C	D	E	F	G	H	I	L	M
<b>700</b>	1048	780	700	700	520	750	700	1430	1043	400	874
<b>900</b>	1248	980	900	900	620	850	900	1530	1143	500	1074
<b>1200</b>	1548	1280	1200	1200	720	950	1200	1630	1243	600	1374

**USE**

- Screening between the atomiser and storage silos
- On the lorry loading lines

**ACCESSORIES AND VERSIONS**

- Supporting carriage
- Carbon steel frame

The information is approximate - The guaranteed values are released by Vibrotech s.r.l. on request-It is forbidden to reproduce the document even partially.